

SAFE BARRIERS - DEFENDER 100 - COMPONENTS

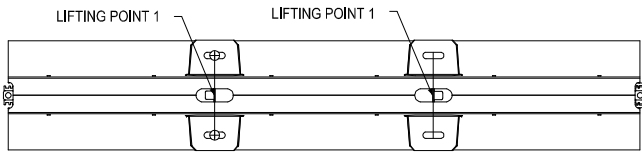

VIEW FROM ABOVE

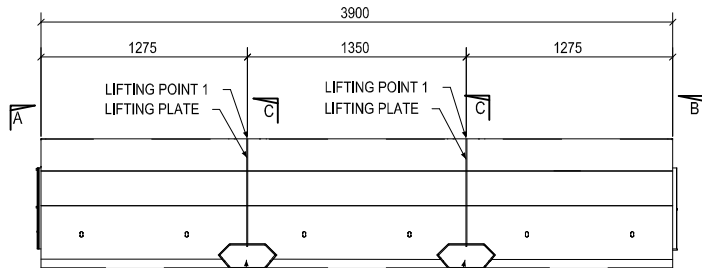

ELEVATION VIEW

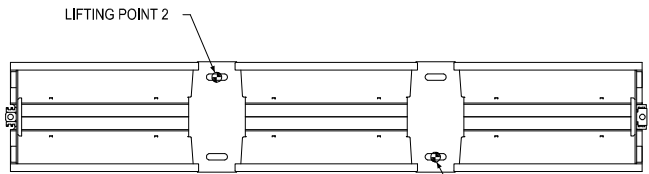

VIEW FROM BELOW

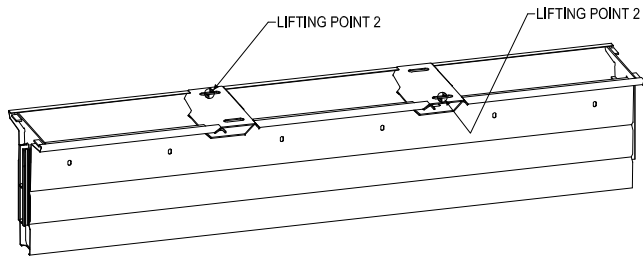

3D VIEW OF INVERTED UNIT

- LIFTING POINTS ARE RATED AT 8 TONNE.
 - NO OTHER PERMISSIBLE LIFTING POINTS OTHER THAN THE ONES INDICATED ON THIS DRAWING.
 - FOR SAFETY RECOMMEND 2 POINTS OF CONNECTION FOR LIFTING

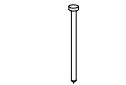

D7 ANCHOR PIN



D10 CONNECTING PIN

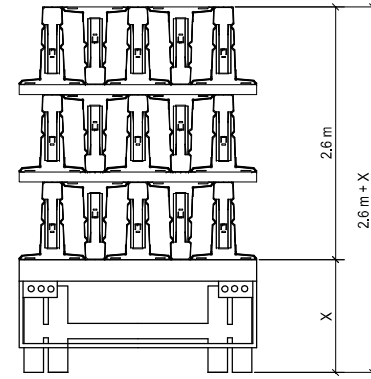

FULL TRUCK LOAD DETAIL
 USING 102 x 102 NOMINAL (89x89 ACTUAL) STEEL DUNNAGE

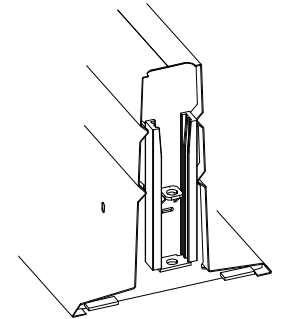

FEMALE END - 3D VIEW

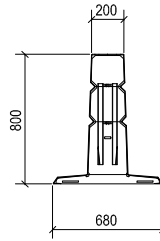

A - A
 MALE END

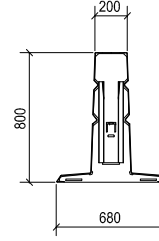

B - B
 FEMALE END

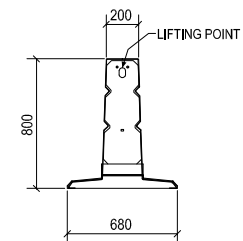

C - C
 LIFTING PLATE

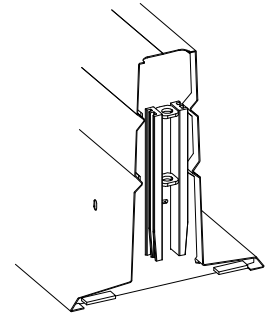

MALE END - 3D VIEW

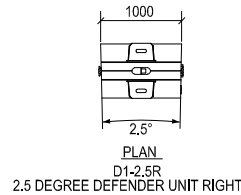

PLAN
 D1-2.5R
 2.5 DEGREE DEFENDER UNIT RIGHT

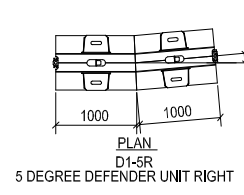

PLAN
 D1-5R
 5 DEGREE DEFENDER UNIT RIGHT

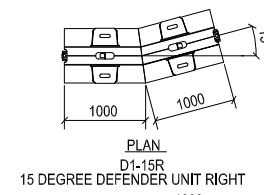

PLAN
 D1-15R
 15 DEGREE DEFENDER UNIT RIGHT

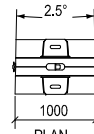

PLAN
 D1-2.5L

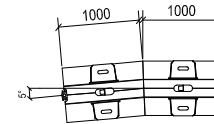

PLAN
 D1-5L

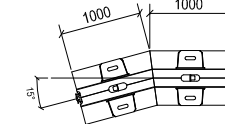

PLAN
 D1-15L

0	29/05/18	ISSUED FOR CONSTRUCTION	JM	DM
A	24/05/18	ISSUED FOR REVIEW	JM	DM
REV	DATE	DESCRIPTION	DRAWN	APPRD.

SAFE BARRIERS

DRAWING DESCRIPTION

DEFENDER BARRIER SYSTEM

DRAWING REF.

SB-D100-A-GA - 0006

DIMENSIONS	MM
DATE	24 May, 2018

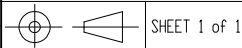

DRAWN BY

JM	CHECKED	CJR	APPROVED	DM
----	---------	-----	----------	----